

ATTACHMENT C

ATTACHMENT C

**ADDITIONAL INFORMATION RELATING TO
1-3 ROSEBERY AVENUE**

1-3 Rosebery Avenue: Additional Information and Images

Current Development on site	
 <p>Eastern Extension</p> <p>Original 1943 Building</p>	<p>Original office building and eastern extension. Fronting Epsom Road. Building is an example of the Inter war functionalist style. Important elements include vertical tower element and glass mullions rising above a porte-cochere. Landscaping to Epsom Road is also visible,</p>
	<p>North western extension to the factory as seen from Epsom Road.</p>

Current Development on site



Single storey addition between the original western elevation of the office building and the north western extension to the factory. Photo also illustrates saw tooth roof form fronting Spring Street.



Entrance to the factory from Rosebery Avenue and incremental additions to the eastern elevation to accommodate amenities and powerhouse.

Current Development on the site



Incremental additions to the eastern extension as viewed from the corner of Epsom Road and Rosebery Avenue. Landscaped setback to building fronting Epsom Road is also visible.



Western elevation of factory and view looking south down Spring Street. Significant saw tooth roof form is illustrated.

Historical Development of the site



1943 aerial photo of the original factory and office building.



Subsequent additions to the warehouse are well designed and integrated with the original format and layout.

Historical Development of the site

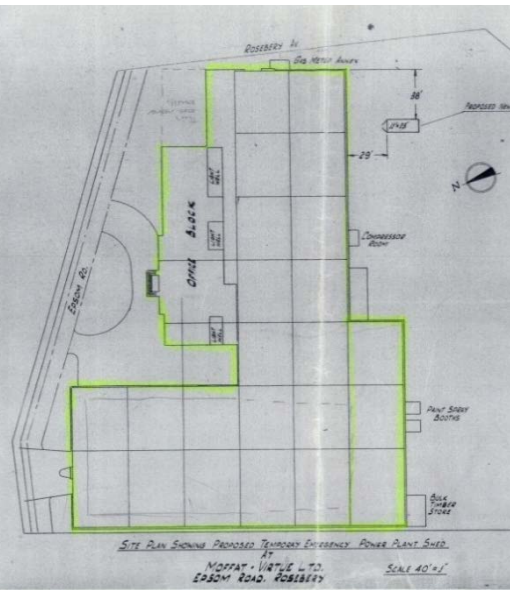

A plan illustrating how additions to the original building are sympathetic in scale and form and align with the original building grid.

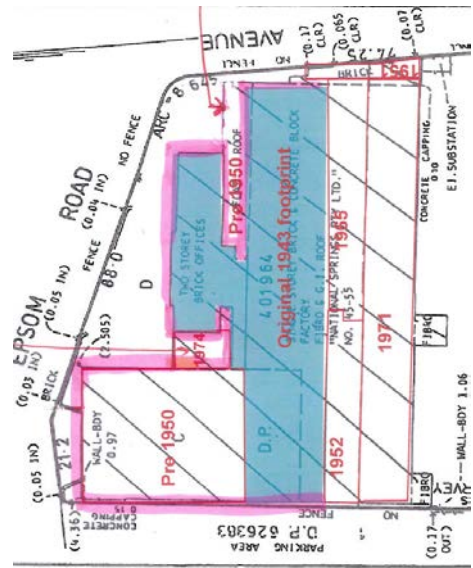

A marked up plan showing the expansion of the site over time. The amended planning controls allow for removal of the southern-most bay of the warehouse which was constructed in 1971.